

NORTH

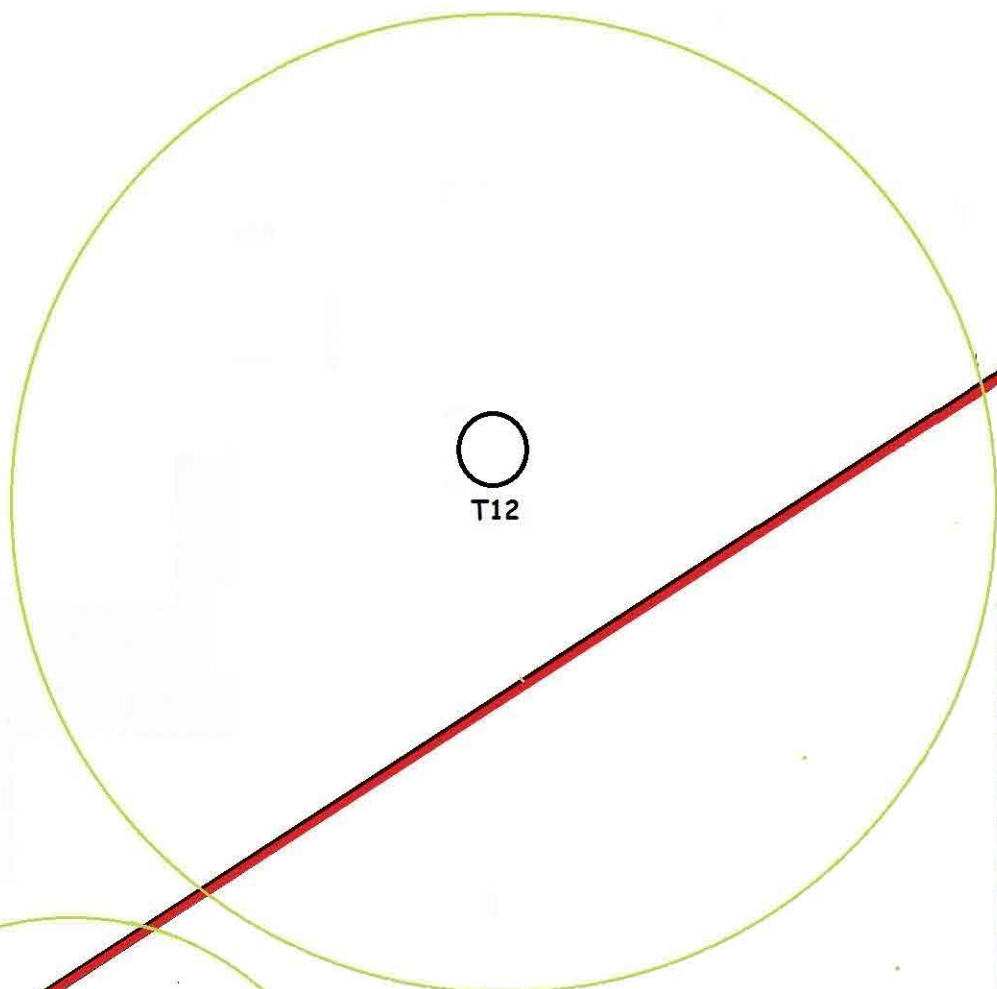

MONKTON  
STADIUM  
CAR PARK



T12

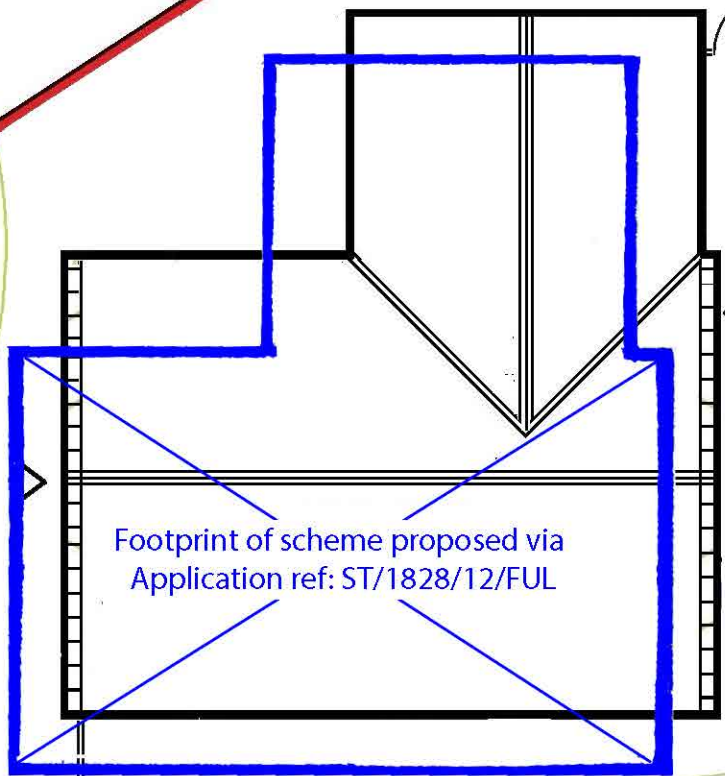

Footprint of scheme proposed via  
Application ref: ST/1828/12/FUL

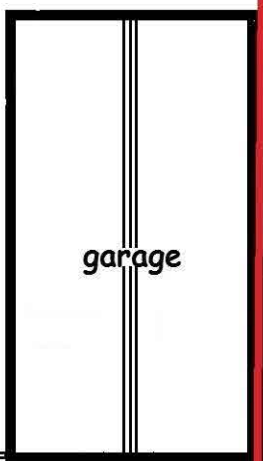

garage

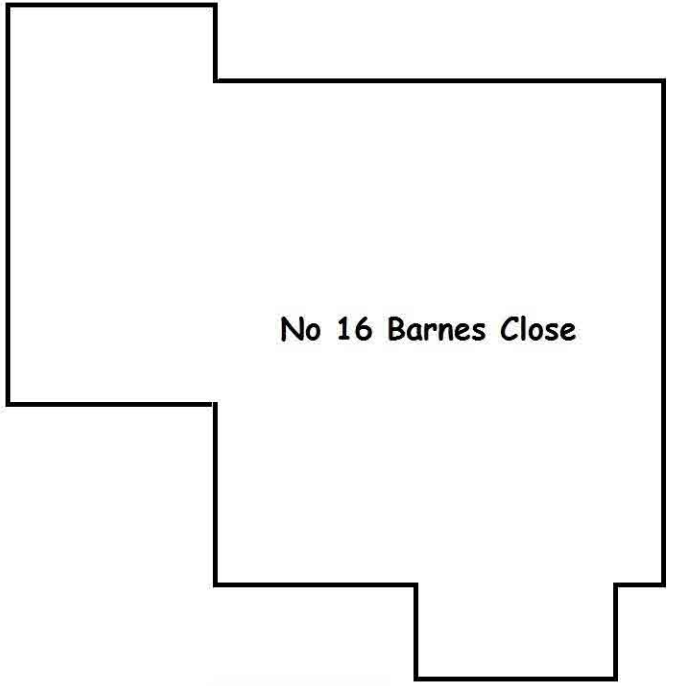

No 16 Barnes Close

T21

T10  
tree to be removed

OPEN SPACE

T8  
tree to be removed

T9

T7

WHITE COTTAGES

Barnes Close  
adopted road



Scale 0 1 2 3 4 5 6 m